

VACUUM MOTOR REPLACEMENT

PBIII AND XLT-60
(120V)

VACUUM MOTOR REMOVAL:

1. **Unplug the machine before starting repairs.**

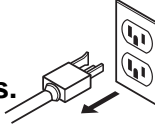

2. Lay the machine on its side with the exhaust port facing up. On older machines, the power cord will also be facing up. (See illustration below). On newer machines the power cord will be on the side of the machine facing down. **Avoid damaging the cord.**
3. Remove the 4 screws holding the bottom caster plate in place. Pull the castor plate away from the bottom of the machine, and disconnect the green ground wire (if applicable) that is attached to the inside of the metal castor plate. There is a slide connector junction located halfway down the wire.
4. For PBIII only, disconnect the pump to the heat exchanger tubing. (See illustration below). At the heat exchanger, use a 1/2" wrench on the compression fitting. **Do not crimp or kink the tubing.**
5. Unscrew the green ground wire from the vacuum motor, using a 5/16" socket or nut driver. (See illustration below).
6. Cut the black wire, extending from the **bottom** of the vacuum motor, a few inches from the point where it joins the other wires in the bundle. (See illustration below). Leave enough wire so it can easily be reconnected to the new vac motor wire.

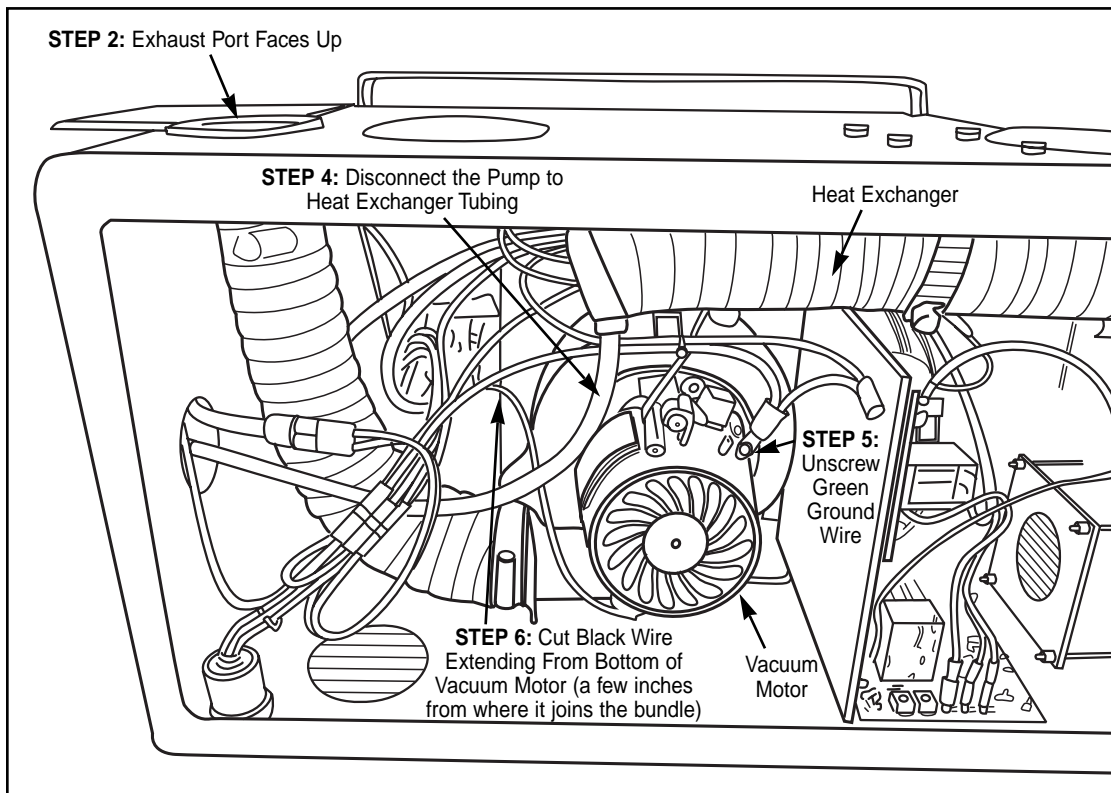

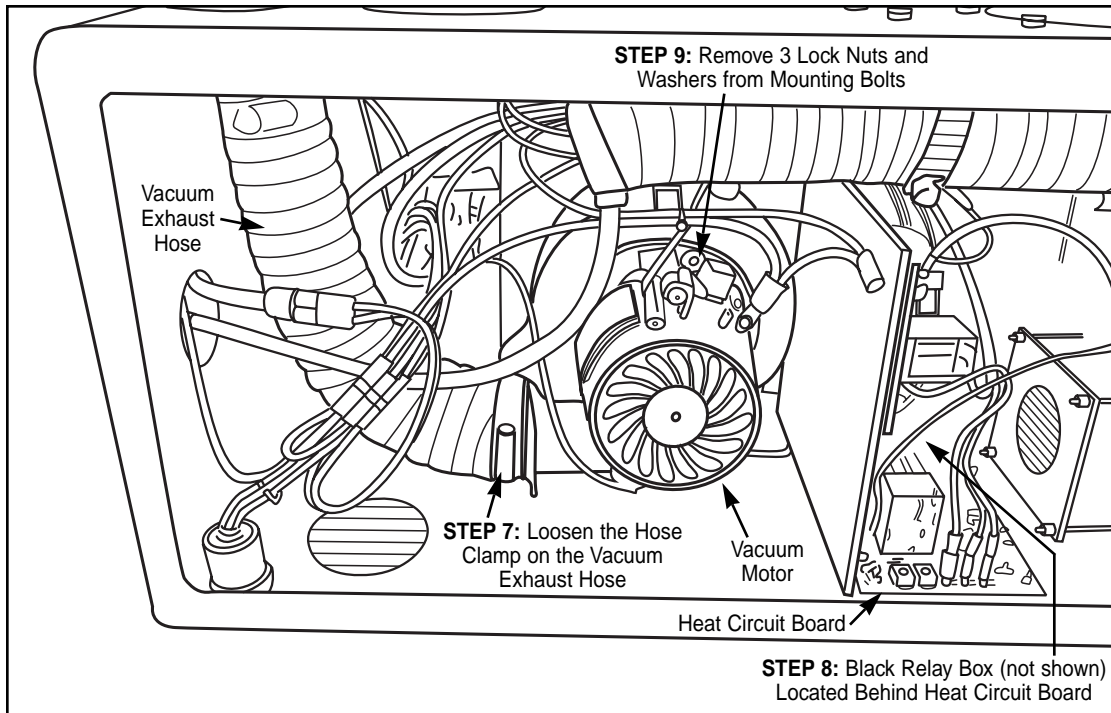

7. Loosen the hose clamp on the vacuum exhaust hose, using a 5/16" socket or nut driver. (See illustration above). Slide the vacuum hose off the vacuum motor port.
8. The remaining black wire extending from the vacuum motor connects to a black relay box located behind the Heat Circuit Board. (See illustration above). Slide the wire off of the terminal (#1)* on the relay.
9. Remove the 3 lock nuts and washers from the mounting bolts. (See illustration above). Gently pull the motor free from the machine. Inspect the vacuum gasket. Replace if necessary (part #419).

VACUUM MOTOR INSTALLATION:

1. Align the new vac motor with the mounting bolts, and slide it on.
2. Install the washers and lock nuts. **Carefully** tighten the nuts in a rotational pattern until all 3 are equally tight and the vacuum motor is just starting to compress the gasket. If the gasket is over compressed, it will restrict the airflow by pushing the vacuum filter against the lift out bucket. **Over-tightening the nuts can damage the motor by compressing the housing.**
3. Strip the wire insulation as necessary and connect the lower vacuum motor wire to the black wire that was cut during removal. Crimp the slide connector to the upper vac motor wire, if necessary, and connect this remaining vac motor wire to the relay (terminal #1).*
4. Attach the ground wires to the vacuum motor.
5. Push the vacuum hose onto the exhaust port on the vacuum and tighten the hose clamp. Make a tight seal so that the vacuum lift is not reduced and the exhaust air does not blow into the base of the machine. **Do not over-tighten.**
6. Reconnect the pump to the heat exchanger solution line. (Not necessary on the XLT-60).

* Refer to the PBIII Schematic and Wiring Diagram.