

VACUUM MOTOR REPLACEMENT

HL-1200, HHP-12, HHP-200 & HHP-300
(120V & 240V)

BEFORE BEGINNING REPAIRS: Unplug the machine, empty all water from the tanks, open the latches and prop the tanks up.

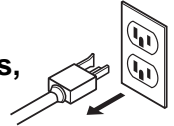

VACUUM MOTOR REMOVAL:

1. Check to be sure the machine is unplugged.

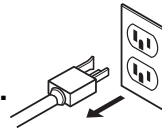

2. Cut the ground wires (green/yellow) from the vac motor, about 3 inches from the insulated butt connector. See Figure 1 below. Leave enough wire for re-connection.
3. Cut and remove the small tie wraps that secure the wiring together. See Figure 1.
4. Locate and cut the 2 power wires from the vac motor, a few inches from the motor. See figure 1 below. Note the correct location of wires. Leave enough wire for reconnection. Leave the power wires connected to the vacuum control circuit board (if applicable).

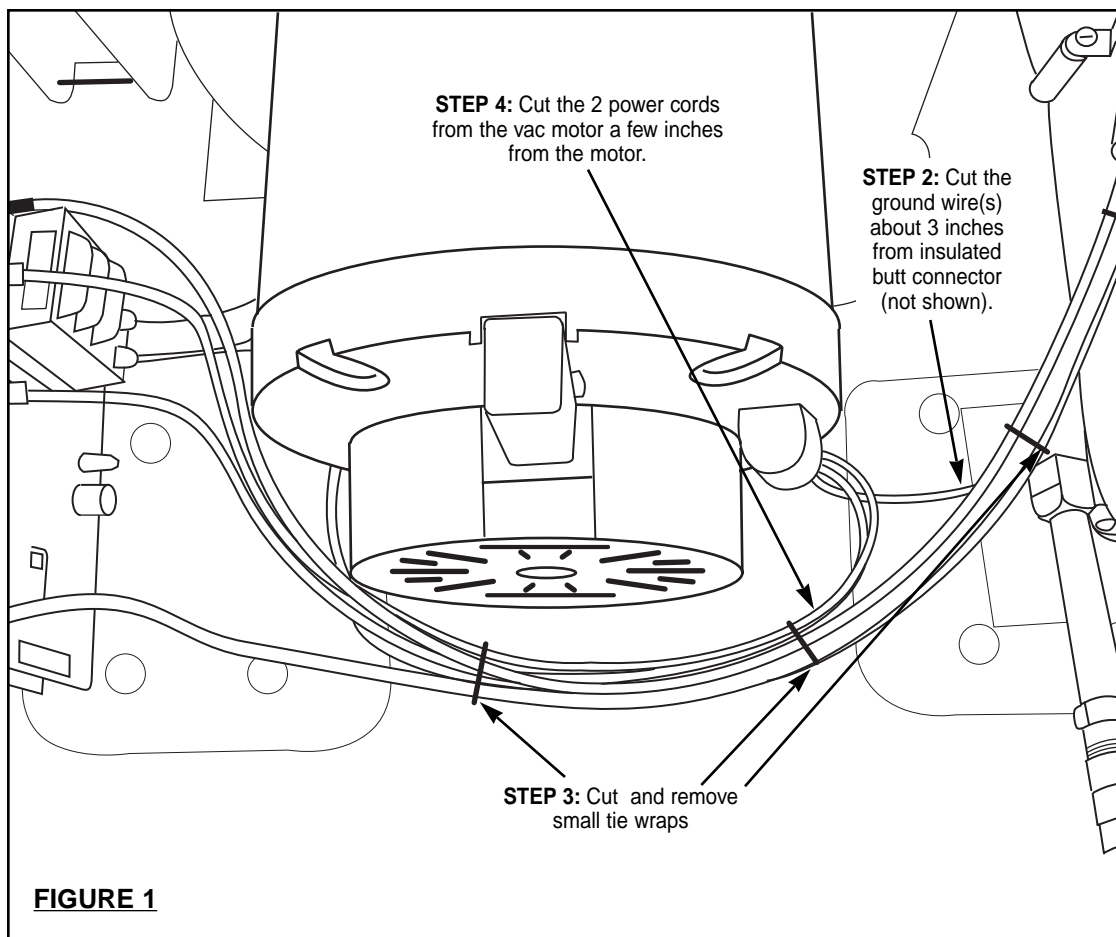

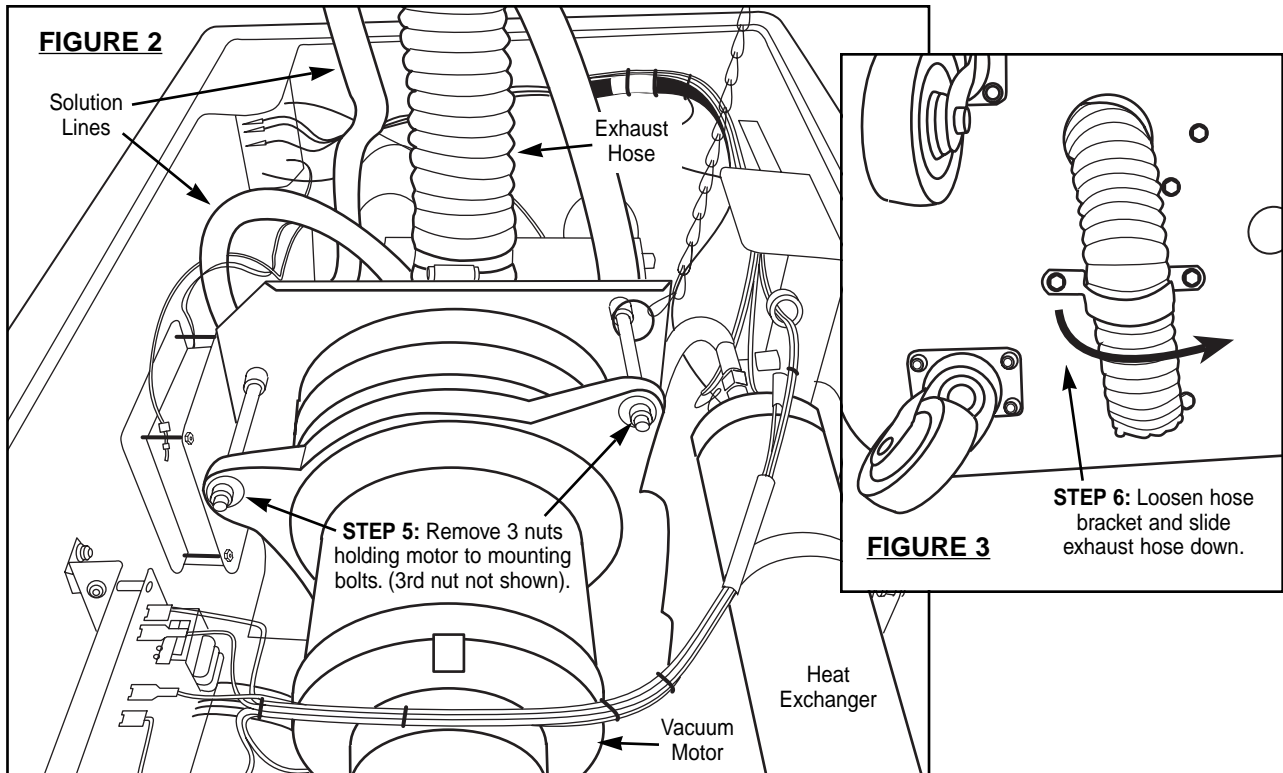

5. Remove the 3 nuts which hold the motor to the mounting bolts. See Figure 2 above.
6. Slide the exhaust vacuum hose (under the machine) down to free the exhaust port on the vacuum motor. You will have to loosen the hose bracket, located underneath the machine, in order to move the bracket aside to free the exhaust hose. See Figure 3 above.
7. Gently pull the vacuum off the mounting bolts. Avoid pulling on the solution line(s) or electrical wires when removing the motor. Replace the vacuum gasket if damaged or worn with part #959.

VACUUM MOTOR INSTALLATION:

1. Align the vacuum motor over the 3 mounting bolts and gently slide it towards the gasket.
2. Tighten the mounting nuts in a **rotational** pattern, until the vacuum gasket begins to compress evenly. **Do not over-tighten, as motor damage may occur.**

NOTE: The bottom nut must not be over-tightened or the vacuum motor exhaust port will push against the mounting plate, resulting in a possible exhaust leak.

3. Slide the exhaust hose up onto the port on the motor. Tighten the hose bracket under the base.
4. Strip the insulation from the wires as necessary.
5. Connect the green ground wire by crimping it into the provided butt connector. **Make sure you have a tight connection. Do not leave bare wires exposed.**
6. Connect the power wires from the motor to the matching power wires that were previously cut. Use the provided butt connectors. Make sure you have a tight connection. Do not leave bare wires exposed. Refer to the wiring diagram for your specific model.